

LEGEND:

- MRT Line & Station
- Future MRT Line & Station
- Under Construction/ Future Road
- (u/c) Under Construction



WL N5 C16

LEGEND

- 2 - Room (Type 1)
- 2 - Room (Type 2)
- 3 - Room
- 4 - Room
- Surrounding Buildings
- Reserved for / Existing Development
- Trellis
- Linkway / Linkbridge (LB) / Precinct Pavilion / Drop-off Porch
- ChildCare Centre (CCC) at 3rd. Storey / Residents' Committee Centre (RCC) / Future Social Community Facilities (FSCF)
- Eating House (EH) /Shop (S) at 1st. Storey / Supermarket (SM) at 2nd. Storey
- Children Playground (PG) / Adult Fitness Station (AFS) / Elderly Fitness Station (EFS)
- Electrical Sub-Station (ESS)
- Utility Centre (UC) at 1st. Storey
- Multi-Storey Car park
- Open Space
- Staircase
- Air-well
- Driveway
- Centralised Refuse Chute/ Chute for Recyclable Refuse
- Corridor
- Lift
- Service Bay

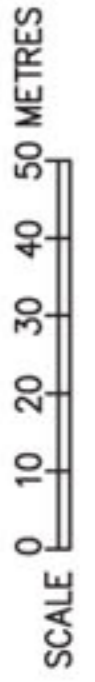
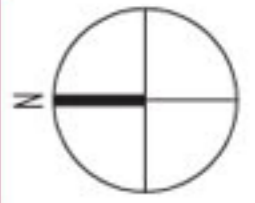

Applicants are encouraged to visit the place before booking a flat.



Block Number	Number of storeys	2 Room (Type 1)	2 Room (Type 2)	3 Room	4 Room	Total	Lift opens at
573A	13	60	12	36	48	156	Every storey
573B	13	-	36	24	72	132	Every storey
573C	13	-	48	48	96	192	Every storey
574A	13	24	72	24	96	216	Every storey
574B	13	-	48	48	96	192	Every storey
Total		84	216	180	408	888	

Standard Flat



Unit Distributions

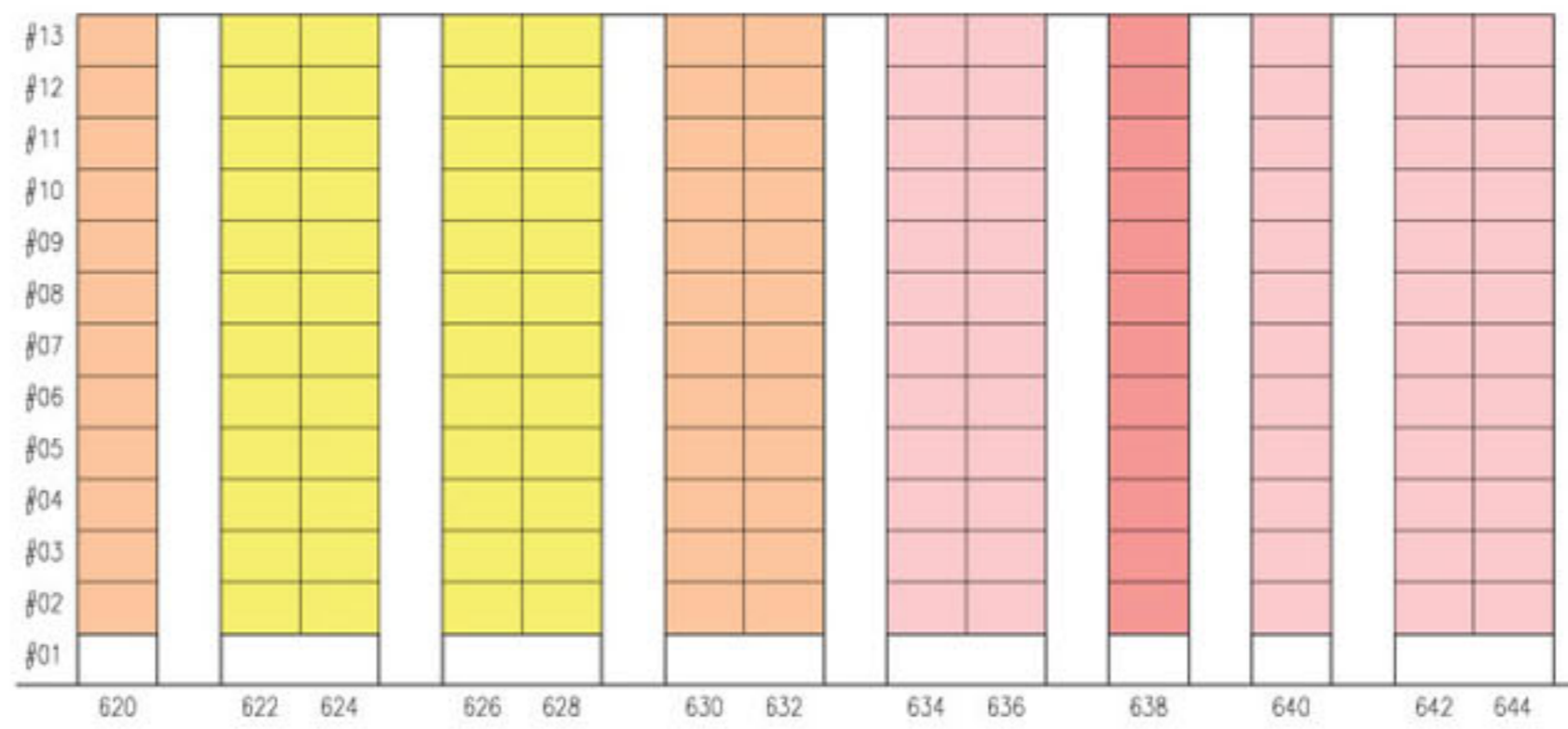

BLOCK 573A

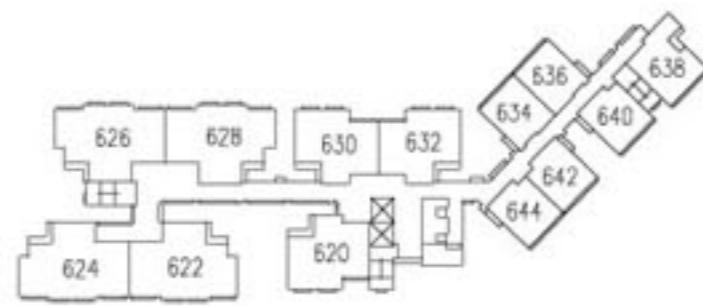

- 2 ROOM (Type 1)
- 2 ROOM (Type 2)
- 3 ROOM
- 4 ROOM

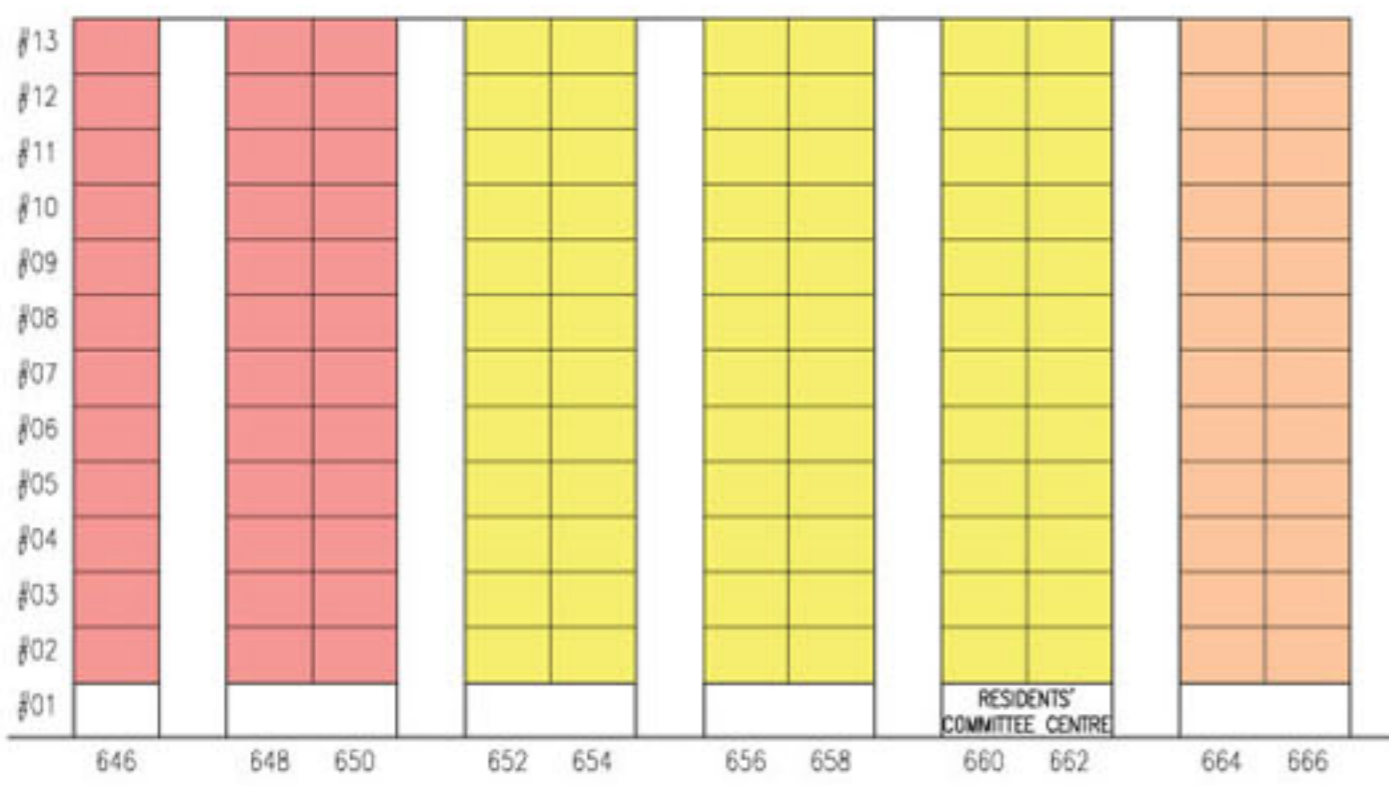

BLOCK 573B

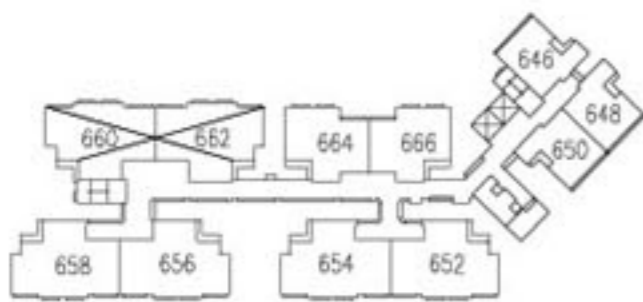

- 2 ROOM (Type 2)
- 3 ROOM
- 4 ROOM

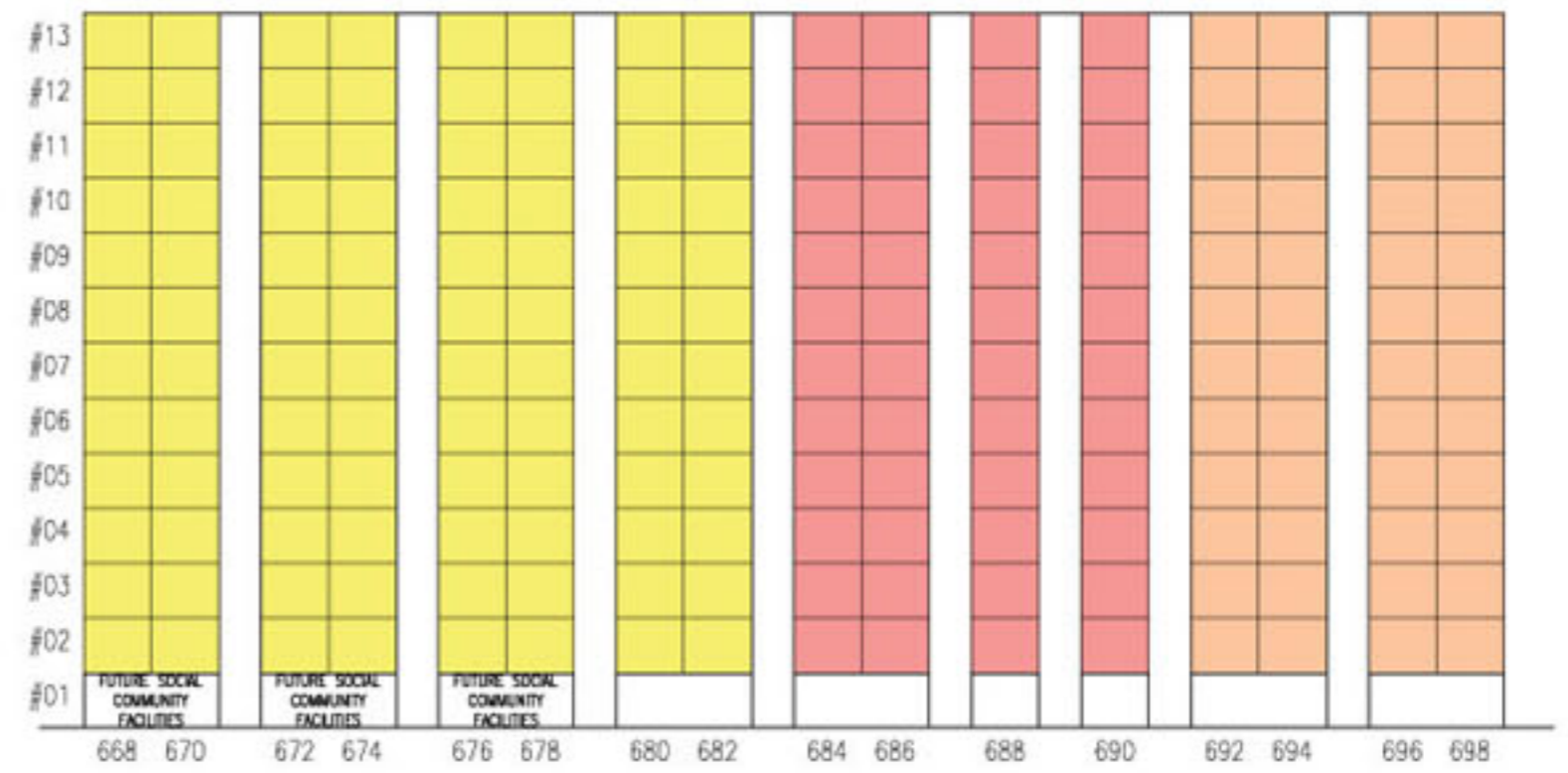

BLOCK 573C

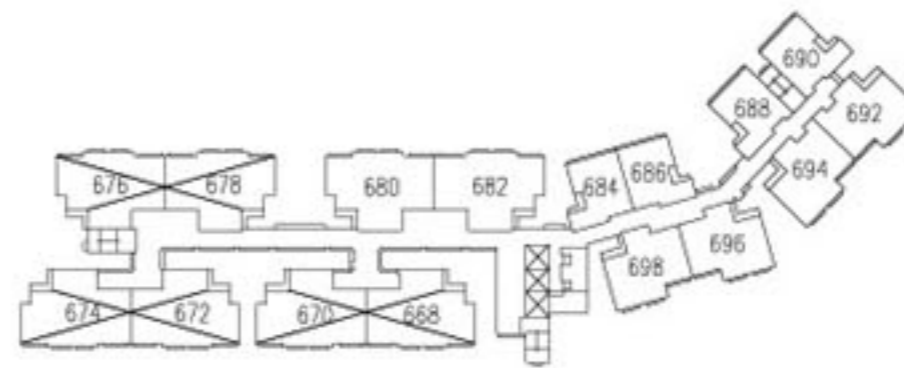

- 2 ROOM (Type 2)
- 3 ROOM
- 4 ROOM



Unit Distributions

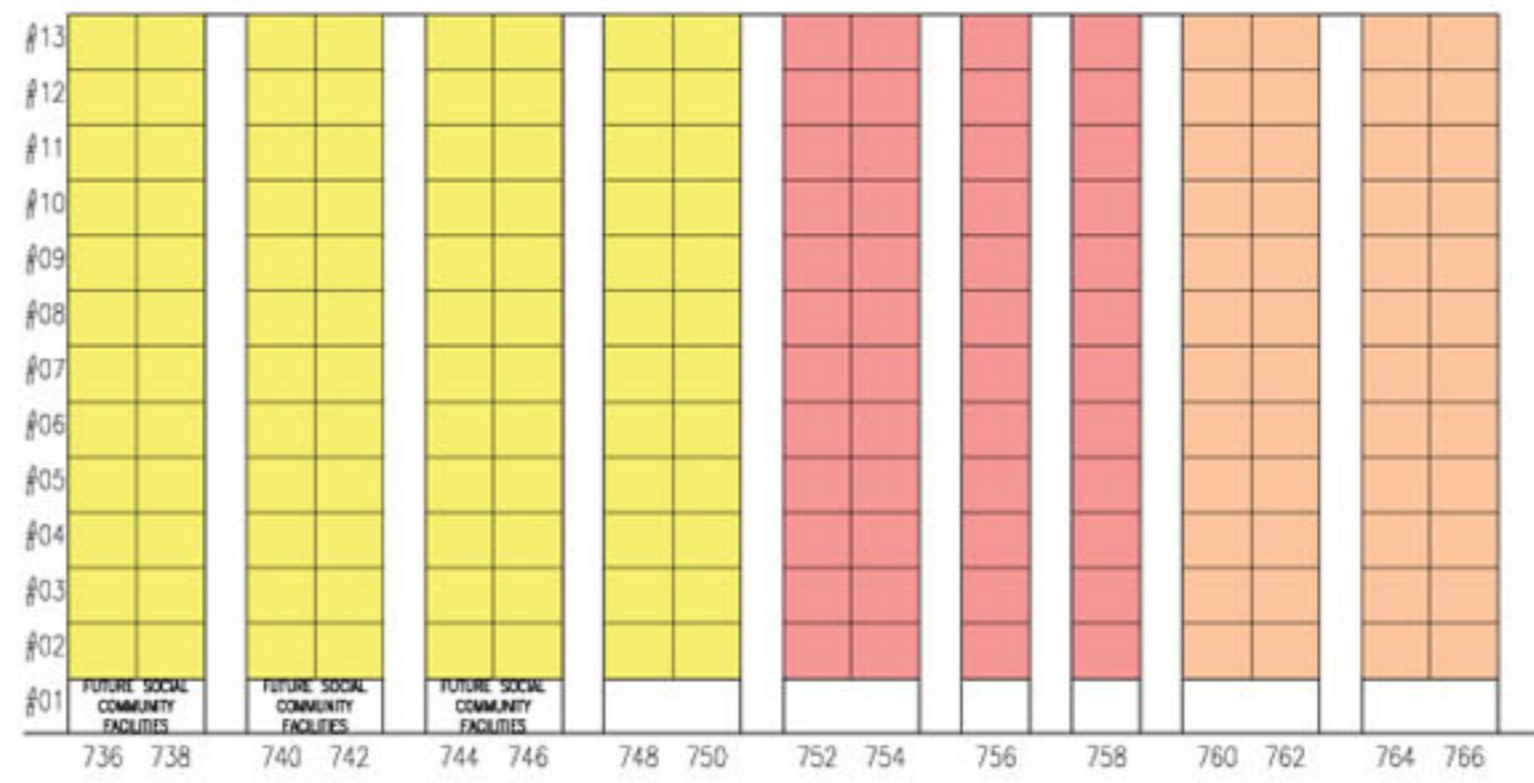
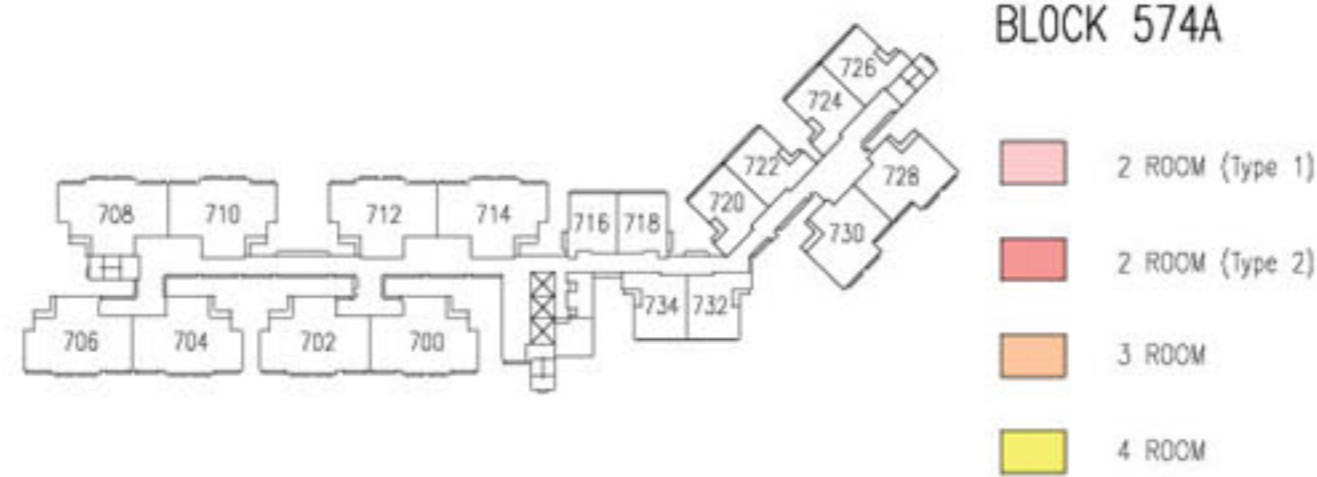
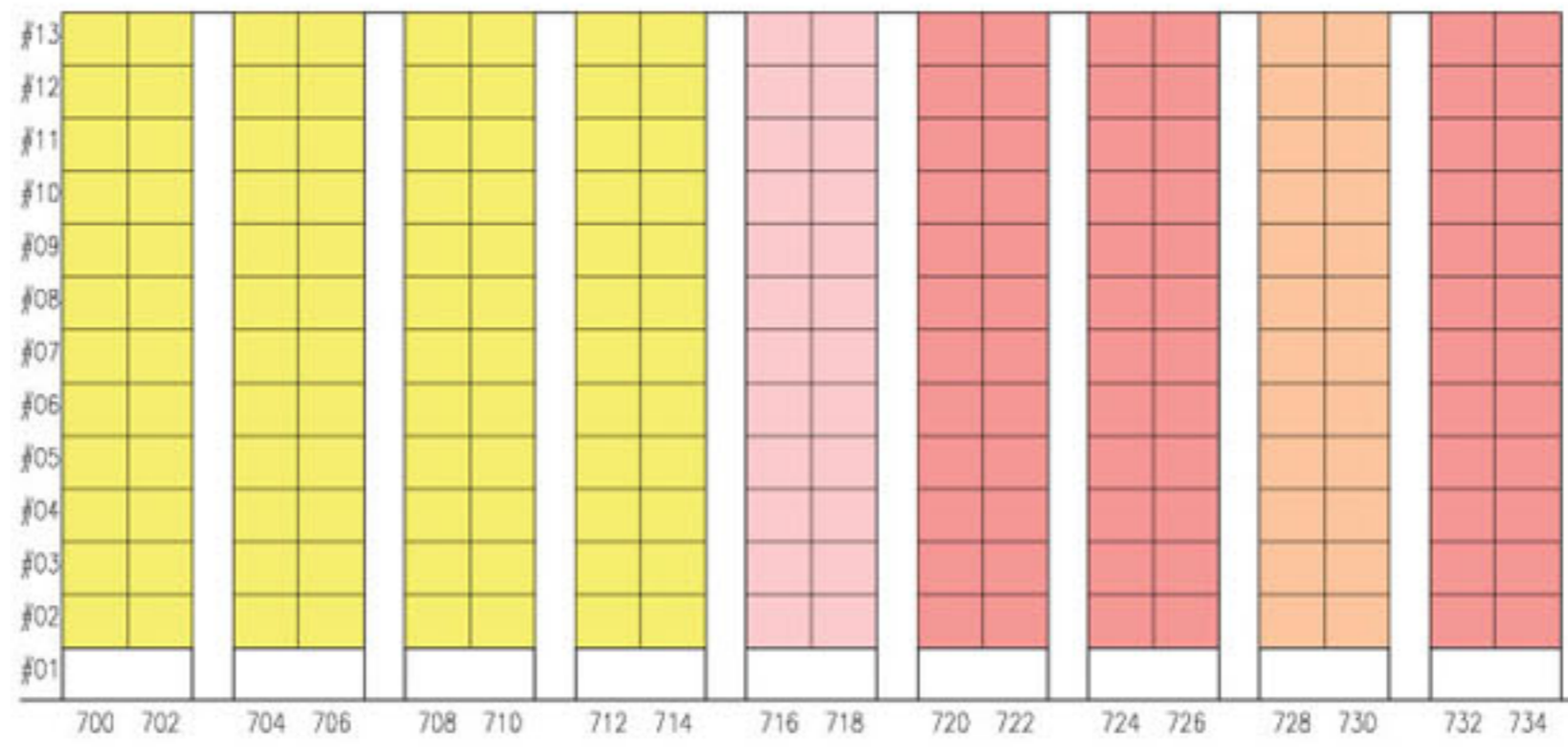



GENERAL SPECIFICATIONS FOR WOODLANDS GLEN

Foundation

Piled foundations.

Structure

Reinforced concrete structural framework with reinforced concrete slabs.

Roof

Reinforced concrete roof slab with precast concrete secondary roofing.

Walls

All external and internal walls are constructed with reinforced concrete/solid blocks/bricks with cement plastering/precast panels/precast lightweight concrete partitions/ drywall partition system.

Windows

Aluminium framed windows with tinted glass.

Doors

Entrance	: decorative solid timber door and metal gate
Bedrooms	: laminated semi-solid timber door (Type D9a) (optional)
	: laminated semi-solid timber sliding partition for 2-Room (Type 1) only
Bathrooms/WC	: acrylic panel folding door for 2-Room
	: laminated semi-solid timber door for 3-Room, 4-Room (Type D9a) (optional)
Household Shelter	: metal door
Service Yard	: aluminium framed door with glass

Finishes

Ceilings	: skim-coated or plastered and painted
Kitchen/Bathrooms/WC walls	: ceramic tiles
Other Walls	: skim-coated or plastered and painted
Living/Dining/Bedrooms floor	: polished porcelain tiles with timber skirting (optional)
Kitchen floor	: glazed porcelain tiles
Bathrooms/WC floor	: ceramic tiles
Service Yard floor	: glazed porcelain tiles with tile skirting
Household shelter floor	: glazed porcelain tiles

Fittings

Quality locksets.
 Water Closet suite.
 Wash basin for Bathroom/WC (optional).
 Bath/Shower mixer with shower set, tap mixer (optional).
 Clothes Drying Rack.

Services

Gas services and concealed water supply pipes.
 Concealed electrical wiring to lighting and power points (including water heater and air-conditioning points).
 Television points.
 Telephone points.

Important Notes:

- 1) The Household Shelter is designed for use as civil defence shelter. The walls, ceiling, floor and door of the Household Shelter shall not be hacked, drilled, altered or removed.
- 2) Air-con panel in the main bedroom will not be provided.
- 3) Any unused or unoccupied open spaces in front of or nearby / adjacent to the flat units are not available for purchase and that the HDB will not entertain any requests from the flat owners to purchase and / or enclose the unused or unoccupied open spaces.

You are advised to visit HDB's website at www.hdb.gov.sg for information on renovations rules.